

BX-VPP 80XR-SG

Stainless steel fixed caster, with top plate fitting, wheel with standard solid rubber tire, with synthetic rim, non-marking, gray

EAN 4047526269029

ID 269027

Customs tariff number 83022000



rig: BX series

- high-quality chromium-nickel steel (1.4301/AISI 304), stainless steel, vibration-ground finishing
- all parts including axle material are corrosion-resistant

Wheel: VPP series

- tire: standard solid rubber, hardness 80 Shore A, color gray, non-marking
- rim: high-quality polypropylene, impact resistant, color black

Other features:

- high chemical resistance to many aggressive substances, except oils
- operating temperature: -20 °C to +60 °C, reduced load capacity over +30 °C

Technical data:

Wheel Ø (D)	80 mm
Wheel width	25 mm
Load capacity at 4 km/h	50 kg
Load capacity (static)	125 kg
Bearing type	roller bearing
Total height (H)	102 mm
Plate size	100 x 85 mm
Bolt hole spacing	80 x 60 mm
Bolt hole Ø	9 mm
Temperature resistance min	-20 °C
Temperature resistance max	60 °C
Tread and tyre hardness	80 Shore A
Unit weight	0.4 kg
Non-marking	✓
Non-staining	✓
Antistatic	✗
Electrically conductive	✗
Corrosion-resistant	✓
Heat-resistant	✗
Tread hydrolysis-resistant	✗
Suitable for autoclaves	✗
Suitable for machine washing	✗



Tread and tyre hardness

80 Shore A

Rolling resistance

satisfactory

Wear resistance

sufficient

Operating noise / floor surface preservation

very good

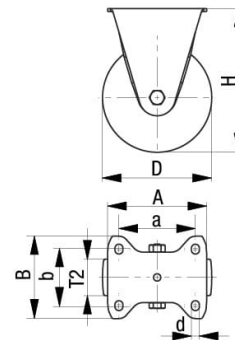

ProductDataSheet.ProductReferences



Corresponding swivel caster LEX-VPP 80XR-SG