

B-PO 100XR

Pressed steel fixed caster, medium duty design, with top plate fitting, nylon wheel

EAN 4047526000752

ID 284638

Customs tariff number 87169090



rig: B series

- pressed steel, zinc-plated, blue-passivated, Cr6-free

Wheel: PO series

- high-quality nylon 6, impact resistant, hardness 70 Shore D, color natural white

Other features:

- high chemical resistance to many aggressive substances
- operating temperature: -25 °C to +80 °C, reduced load capacity over +35 °C



Technical data:

Wheel Ø (D)	☉	100 mm
Wheel width	⊥	37 mm
Load capacity at 4 km/h	⬆	250 kg
Load capacity (static)	⬆	625 kg
Bearing type	☉	roller bearing
Total height (H)	⌀	125 mm
Plate size	☐	100 x 85 mm
Bolt hole spacing	⌘	80 x 60 mm
Bolt hole Ø	⌀	9 mm
Temperature resistance min		-25 °C
Temperature resistance max		80 °C
Tread and tyre hardness		70 Shore D
Unit weight	⚖	0.6 kg
Non-marking		✓
Non-staining		✓
Antistatic	⚡	✗
Electrically conductive	⚡	✗
Corrosion-resistant		✗
Heat-resistant	🔥	✗
Tread hydrolysis-resistant		✗
Suitable for autoclaves		✗
Suitable for machine washing		✗

Tread and tyre hardness

■ ■ ■ ■ ■ 70 Shore D

Rolling resistance

■ ■ ■ ■ ■ excellent

Wear resistance

■ ■ ■ □ □ good

Operating noise / floor surface preservation

■ ■ □ □ □ satisfactory

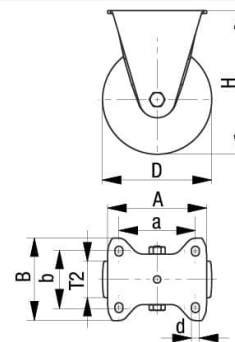

Product references



Corresponding swivel caster L-PO 100XR



Wheel used PO 100/12XR