

## BK-POTH 100KA-1-FA

Pressed steel fixed caster, heavy duty design, with top plate fitting, wheel with thermoplastic polyurethane tread, with heavy duty nylon wheel center, with synthetic thread guard, small, with steel thread guard

EAN 4047526004354

ID 350470

Customs tariff number 87169090



**rig:** BK series

- strong pressed steel, zinc-plated, blue-passivated, Cr6-free

**Wheel:** POTH series

- tread: high-quality thermoplastic polyurethane (TPU), hardness 94 Shore A, color dark gray, non-marking, non-staining
- wheel center: high-quality nylon 6, impact resistant, color natural white

**Other features:**

- with synthetic thread guard, small
- very high chemical resistance to many aggressive substances
- operating temperature: -5 °F to +160 °F, temporarily up to +195 °F, reduced load capacity over +95 °F

### Technical data:

Wheel Ø (D)	☉	100 mm
Wheel width	⊥	35 mm
Load capacity at 4 km/h	⬆	300 kg
Load capacity (static)	⬆	750 kg
Bearing type	☉	ball bearing (C)
Total height (H)	⊕	130 mm
Plate size	☐	100 x 85 mm
Bolt hole spacing	⊕	80 x 60 mm
Bolt hole Ø	⌀	9 mm
Temperature resistance min		-20 °C
Temperature resistance max		70 °C
Tread and tyre hardness		94 Shore A
Unit weight	⚖	0.7 kg
Non-marking		✓
Non-staining		✓
Antistatic	⚡	✗
Electrically conductive	⚡	✗
Corrosion-resistant		✗
Heat-resistant	🔥	✗
Tread hydrolysis-resistant		✗
Suitable for autoclaves		✗
Suitable for machine washing		✗



### Tread and tyre hardness

■ ■ ■ ■ ■ 94 Shore A

### Rolling resistance

■ ■ ■ ■ ■ very good

### Wear resistance

■ ■ ■ ■ ■ very good

### Operating noise / floor surface preservation

■ ■ ■ ■ ■ good

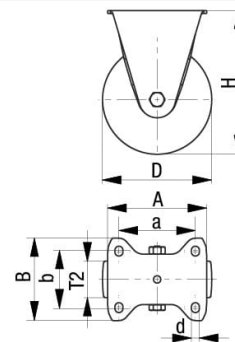

## Product references



**Corresponding swivel caster LK-POTH 100KA-1-FA**



**Wheel used POTH 100/10KA**