

LK-PO 100XR-1-ST

Pressed steel swivel caster, heavy duty design, with brake system 'stop-top', nylon wheel

EAN 4047526416010

ID 416016

Customs tariff number 87169090



rig: LK series

- strong pressed steel, zinc-plated, blue-passivated, Cr6-free
- double ball bearing in the swivel head
- strong central kingpin (from wheel Ø 125x50 mm)
- swivel head seal
- minimum swivel head play and smooth rolling characteristic and increased service life due to the special dynamic Blickle riveting process

Wheel: PO series

- high-quality nylon 6, impact resistant, hardness 70 Shore D, color natural white

Other features:

- high chemical resistance to many aggressive substances
- operating temperature: -25 °C to +80 °C, reduced load capacity over +35 °C

Technical data:

Wheel Ø (D)	☉	100 mm
Wheel width	⊥	37 mm
Load capacity at 4 km/h	⬆	280 kg
Load capacity (static)	⬆	700 kg
Bearing type	☉	roller bearing
Total height (H)	⌀	130 mm
Plate size	☐	100 x 85 mm
Bolt hole spacing	⊞	80 x 60 mm
Bolt hole Ø	⌀	9 mm
Offset (F)	⌀	47 mm
Temperature resistance min		-25 °C
Temperature resistance max		70 °C
Tread and tyre hardness		70 Shore D
Unit weight	⚖	1.2 kg
Non-marking		✓
Non-staining		✓
Antistatic	☑	×
Electrically conductive	☑	×
Corrosion-resistant		×
Heat-resistant	☑	×
Tread hydrolysis-resistant		×
Suitable for autoclaves		×
Suitable for machine washing		×



Tread and tyre hardness

■■■■■ 70 Shore D

Rolling resistance

■■■■■ excellent

Wear resistance

■■■■□ good

Operating noise / floor surface preservation

■■■■□ satisfactory

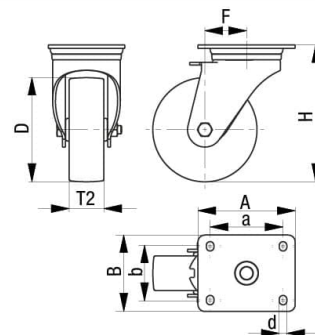
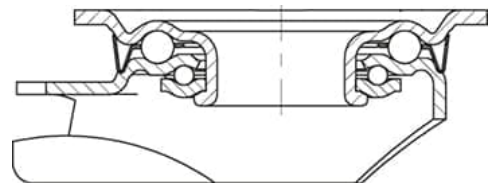

Product references



Corresponding rigid caster BK-PO 100XR-1



Corresponding swivel caster LK-PO 100XR-1



Wheel used PO 100/15XR