

## B-POTH 200K

**Pressed steel fixed caster, medium duty design, with top plate fitting, wheel with thermoplastic polyurethane tread, with heavy duty nylon wheel center**

**EAN** 4047526044688

**ID** 44685

**Customs tariff number** 87169090



**rig:** B series

- pressed steel, zinc-plated, blue-passivated, Cr6-free

**Wheel:** POTH series

- tread: high-quality thermoplastic polyurethane (TPU), hardness 94 Shore A, color dark gray, non-marking, non-staining
- wheel center: high-quality nylon 6, impact resistant, color natural white

**Other features:**

- very high chemical resistance to many aggressive substances
- operating temperature: -5 °F to +160 °F, temporarily up to +195 °F, reduced load capacity over +95 °F

### Technical data:

Wheel Ø (D)	☞	200 mm
Wheel width	⏏	50 mm
Load capacity at 4 km/h	⏏	400 kg
Load capacity (static)	⏏	1,000 kg
Bearing type	☉	ball bearing
Total height (H)	⌀	235 mm
Plate size	⏏	140 x 110 mm
Bolt hole spacing	⏏	105 x 75–80 mm
Bolt hole Ø	⌀	11 mm
Temperature resistance min		-20 °C
Temperature resistance max		70 °C
Tread and tyre hardness		94 Shore A
Unit weight	⏏	2.1 kg
Non-marking	✓	
Non-staining	✓	
Antistatic	✗	
Electrically conductive	✗	
Corrosion-resistant	✗	
Heat-resistant	✗	
Tread hydrolysis-resistant	✗	
Suitable for autoclaves	✗	
Suitable for machine washing	✗	



### Tread and tyre hardness

94 Shore A

### Rolling resistance

very good

### Wear resistance

very good

### Operating noise / floor surface preservation

good

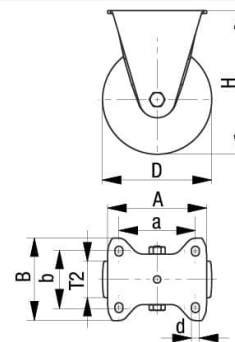

## Product references



**Corresponding swivel caster L-POTH 200K**



**Wheel used POTH 200/20K**