

BH-POEV 160R-SG

Pressed steel fixed caster, heavy duty design, with top plate fitting, heavy duty wheel, with "Blickle EasyRoll" elastic solid rubber tires, with nylon wheel center, non-marking, gray

EAN 4047526446970

ID 446971

Customs tariff number 87169090



rig: BH series

- pressed steel, zinc-plated, blue-passivated, Cr6-free
- heavy fork and top plate

Wheel: POEV series

- tire: high-quality elastic solid rubber "Blickle EasyRoll" in smooth rolling quality, hardness 65 Shore A, color gray, non-marking
- wheel center: high-quality nylon 6, impact resistant, color black

Other features:

- high chemical resistance to many aggressive substances, except oils
- operating temperature: -15 °F to +175 °F, temporarily up to +210 °F, reduced load capacity over +95 °F



Technical data:

Wheel Ø (D)	⌀	160 mm
Wheel width	⊥	50 mm
Load capacity at 4 km/h	⬆	400 kg
Load capacity (static)	⬆	1,000 kg
Bearing type	⊙	roller bearing
Total height (H)	⊥	202 mm
Plate size	⊞	140 x 110 mm
Bolt hole spacing	⊞	105 x 75–80 mm
Bolt hole Ø	⌀	11 mm
Temperature resistance min		-25 °C
Temperature resistance max		80 °C
Tread and tyre hardness		65 Shore A
Unit weight	⚖	2 kg
Non-marking		✓
Non-staining		✓
Antistatic	⚡	✗
Electrically conductive	⚡	✗
Corrosion-resistant		✗
Heat-resistant	🔥	✗
Tread hydrolysis-resistant		✗
Suitable for autoclaves		✗
Suitable for machine washing		✗

Tread and tyre hardness

■ ■ ■ ■ ■ 65 Shore A

Rolling resistance

■ ■ ■ ■ ■ very good

Wear resistance

■ ■ ■ ■ ■ good

Operating noise / floor surface preservation

■ ■ ■ ■ ■ very good

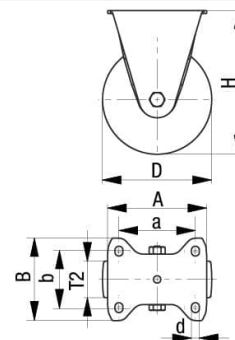

Product references



Corresponding swivel caster LH-POEV 160R-SG



Wheel used POEV 160/20R-SG