

BK-POEV 125KA-3-SB

Pressed steel fixed caster, heavy duty design, with top plate fitting, heavy duty wheel, with "Blickle EasyRoll" elastic solid rubber tires, with nylon wheel center, non-marking, blue, with synthetic thread guard, small

EAN 4047526591946

ID 591941

Customs tariff number 87169090



rig: BK series

- strong pressed steel, zinc-plated, blue-passivated, Cr6-free

Wheel: POEV series

- tire: high-quality elastic solid rubber "Blickle EasyRoll" in smooth rolling quality, hardness 65 Shore A, color blue, non-marking
- wheel center: high-quality nylon 6, impact resistant, color black

Other features:

- with synthetic thread guard, small
- high chemical resistance to many aggressive substances, except oils
- operating temperature: -5 °F to +175 °F, temporarily up to +210 °F, reduced load capacity over +95 °F



Technical data:

Wheel Ø (D)	⌀	125 mm
Wheel width	⊥	37 mm
Load capacity at 4 km/h	⬆	250 kg
Load capacity (static)	⬆	625 kg
Bearing type	⊙	ball bearing (C)
Total height (H)	⊗	155 mm
Plate size	⊞	140 x 110 mm
Bolt hole spacing	⊞	105 x 75–80 mm
Bolt hole Ø	⌀	11 mm
Temperature resistance min		-20 °C
Temperature resistance max		80 °C
Tread and tyre hardness		65 Shore A
Unit weight	⚖	0.9 kg
Non-marking		✓
Non-staining		✓
Antistatic	⚡	✗
Electrically conductive	⚡	✗
Corrosion-resistant		✗
Heat-resistant	🔥	✗
Tread hydrolysis-resistant		✗
Suitable for autoclaves		✗
Suitable for machine washing		✗

Tread and tyre hardness

■■■■■ 65 Shore A

Rolling resistance

■■■■■ very good

Wear resistance

■■■■■ good

Operating noise / floor surface preservation

■■■■■ very good

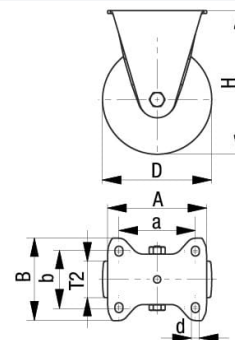

Product references



Corresponding swivel caster LK-POEV 125KA-3-SB



Wheel used POEV 125/10KA-SB