

BH-VW 252R

Pressed steel fixed caster, heavy duty design, with top plate fitting, wheel with "Blickle Soft" soft rubber tire, with pressed steel rim

EAN 4047526603724

ID 603720

Customs tariff number 87169090



rig: BH series

- pressed steel, zinc-plated, blue-passivated, Cr6-free
- heavy fork and top plate

Wheel: VW series

- tire: soft rubber "Blickle Soft", hardness 50 Shore A, color black (wheel Ø 260 mm with additional hard rubber core)
- rim: pressed steel, strong rim structure with tubular steel hub, bolted or pressed, zinc-plated, blue-passivated, Cr6-free

Other features:

- chemical resistance to many aggressive substances, except oils
- operating temperature: -25 °C to +80 °C, reduced load capacity over +60 °C
- puncture-proof alternatives for pneumatic tires



Technical data:

Wheel Ø (D)	☉	250 mm
Wheel width	⊥	60 mm
Load capacity at 4 km/h	⬆	160 kg
Load capacity (static)	⬆	400 kg
Bearing type	☉	roller bearing
Profile		round profile
Total height (H)	⊕	295 mm
Plate size	📏	140 x 110 mm
Bolt hole spacing	🔧	105 x 75–80 mm
Bolt hole Ø	🔧	11 mm
Temperature resistance min		-25 °C
Temperature resistance max		70 °C
Tread and tyre hardness		50 Shore A
Unit weight	⚖	4.6 kg
Non-marking		×
Non-staining		×
Antistatic	⚡	×
Electrically conductive	⚡	×
Corrosion-resistant		×
Heat-resistant	🔥	×
Tread hydrolysis-resistant		×
Suitable for autoclaves		×
Suitable for machine washing		×

Tread and tyre hardness

■ ■ ■ ■ ■ 50 Shore A

Rolling resistance

■ ■ ■ ■ ■ good

Wear resistance

■ ■ ■ ■ ■ satisfactory

Operating noise / floor surface preservation

■ ■ ■ ■ ■ excellent

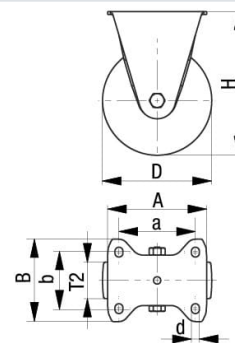

Product references



Corresponding swivel caster L-VW 252R-3



Wheel used VW 252/25R