

B-PO 200K-ELS

Pressed steel fixed caster, medium duty design, with top plate fitting, nylon wheel, electrically conductive, Non-marking

EAN 4047526614102

ID 614107

Customs tariff number 87169090



rig: B series

- pressed steel, zinc-plated, blue-passivated, Cr6-free

Wheel: PO series

- high-quality nylon 6, impact resistant, hardness 70 Shore D, color gray, non-marking

Other features:

- high chemical resistance to many aggressive substances
- operating temperature: -20 °C to +80 °C, reduced load capacity over +35 °C
- electrical conductivity (ohmic resistance) $\leq 10^4 \Omega$

Technical data:

Wheel Ø (D)	☯	200 mm
Wheel width	⏏	50 mm
Load capacity at 4 km/h	⚖	400 kg
Load capacity (static)	⚖	1,000 kg
Bearing type	⦿	ball bearing
Total height (H)	⦿	235 mm
Plate size	📏	140 x 110 mm
Bolt hole spacing	📏	105 x 75–80 mm
Bolt hole Ø	🔧	11 mm
Temperature resistance min		-20 °C
Temperature resistance max		80 °C
Tread and tyre hardness		70 Shore D
Unit weight	⚖	1.9 kg
Non-marking	✓	
Non-staining	✓	
Antistatic	✗	
Electrically conductive	✓	
Corrosion-resistant	✗	
Heat-resistant	✗	
Tread hydrolysis-resistant	✗	
Suitable for autoclaves	✗	
Suitable for machine washing	✗	



Tread and tyre hardness

70 Shore D

Rolling resistance

excellent

Wear resistance

good

Operating noise / floor surface preservation

satisfactory

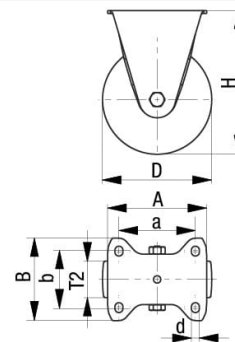

Product references



Corresponding swivel caster L-PO 200K-ELS



Wheel used PO 200/20K-ELS