

LER-VPP 100R-SG

Pressed steel swivel caster, with bolt hole fitting, wheel with standard solid rubber tire, with synthetic rim, non-marking, gray

EAN 4047526108410

ID 620203

Customs tariff number 87169090



rig: LER series

- pressed steel, zinc-plated, blue-passivated, Cr6-free
- double ball bearing in the swivel head
- strong central kingpin
- minimum swivel head play and smooth rolling characteristic and increased service life due to the special dynamic Blickle riveting process

Wheel: VPP series

- tire: standard solid rubber, hardness 80 Shore A, color gray, non-marking
- rim: high-quality polypropylene, impact resistant, color black

Other features:

- high chemical resistance to many aggressive substances, except oils
- operating temperature: -20 °C to +60 °C, reduced load capacity over +30 °C

Technical data:

Wheel Ø (D)	☉	100 mm
Wheel width	⊥	30 mm
Load capacity at 4 km/h	⬆	70 kg
Load capacity (static)	⬆	175 kg
Bearing type	☉	roller bearing
Total height (H)	⌀	125 mm
Plate Ø	⌀	70 mm
Bolt hole	🔩	13 mm
Offset (F)	⌀	36 mm
Temperature resistance min		-20 °C
Temperature resistance max		60 °C
Tread and tyre hardness		80 Shore A
Unit weight	⚖	0.6 kg
Non-marking	✓	
Non-staining	✓	
Antistatic	⚡	×
Electrically conductive	⚡	×
Corrosion-resistant		×
Heat-resistant	🔥	×
Tread hydrolysis-resistant		×
Suitable for autoclaves		×
Suitable for machine washing		×



Tread and tyre hardness

■ ■ ■ ■ □ 80 Shore A

Rolling resistance

■ ■ □ □ □ satisfactory

Wear resistance

■ □ □ □ □ sufficient

Operating noise / floor surface preservation

■ ■ ■ ■ □ very good

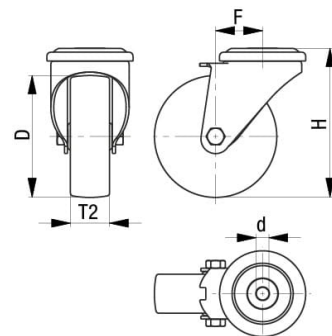
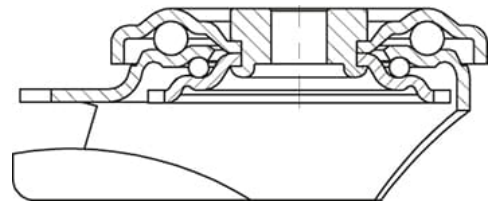

Product references



Corresponding standard locking LER-VPP 100R-FI-SG



Wheel used VPP 100/12R-SG