

## LKR-ALTH 100K-FI-AS

Pressed steel swivel caster, heavy duty design, with bolt hole, with brake system 'stop-fix', heavy duty wheel with Blickle Extrathane® polyurethane tread, with aluminum wheel center, antistatic

EAN 4047526628239

ID 628230

Customs tariff number 87169090



### rig: LKR series

- strong pressed steel, zinc-plated, blue-passivated, Cr6-free
- double ball bearing in the swivel head
- strong central kingpin
- minimum swivel head play and smooth rolling characteristic and increased service life due to the special dynamic Blickle riveting process

### Wheel: ALTH series

- tread: high-quality polyurethane elastomer Blickle Extrathane®, hardness 92 Shore A, color gray, non-marking, non-staining
- wheel center: die-cast aluminium, color silver gray

### Other features:

- high chemical resistance to many aggressive substances
- operating temperature: -5 °F to +160 °F, temporarily up to +195 °F, reduced load capacity over +105 °F
- electrical conductivity (ohmic resistance)  $\leq 10^7 \Omega$

### Technical data:

Wheel Ø (D)	⌀	100 mm
Wheel width	⊥	40 mm
Load capacity at 4 km/h	⊞	350 kg
Load capacity (static)	⊞	875 kg
Bearing type	⊙	ball bearing
Total height (H)	⌀	130 mm
Plate Ø	⌀	88 mm
Bolt hole	⌀	13 mm
Offset (F)	⌀	49 mm
Temperature resistance min		-20 °C
Temperature resistance max		70 °C
Tread and tyre hardness		92 Shore A
Unit weight	⊞	1.4 kg
Non-marking		✓
Non-staining		✓
Antistatic	⊞	✓
Electrically conductive	⊞	✗
Corrosion-resistant		✗
Heat-resistant	⊞	✗
Tread hydrolysis-resistant		✗
Suitable for autoclaves		✗
Suitable for machine washing		✗



### Tread and tyre hardness

■■■■■□ 92 Shore A

### Rolling resistance

■■■■■□ very good

### Wear resistance

■■■■■□ excellent

### Operating noise / floor surface preservation

■■■■■□ good

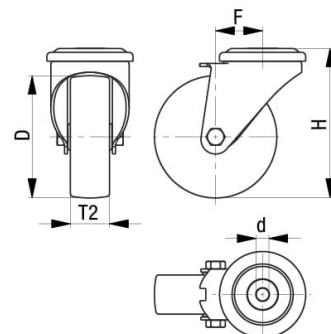
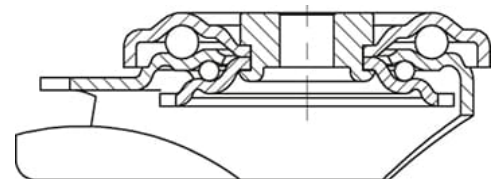

## Product references



**Corresponding swivel caster LKR-ALTH 100K-AS**



**Wheel used ALTH 100/15K-AS**