

LMDA-TPA 75KF-FI-ELS

Light duty twin wheel swivel caster, with brake system 'stop-fix', wheel with thermoplastic rubber tread, with polypropylene wheel center, with synthetic thread guard, large, electrically conductive, Non-marking

EAN 4047526637767

ID 637769

Customs tariff number 83022000



rig: LMDA series

- pressed steel, zinc-plated, blue-passivated, Cr6-free
- double ball bearing in the swivel head
- pressed swivel head

Wheel: TPA series

- tread: high-quality thermoplastic rubber-elastomer (TPE), hardness 85 Shore A, color gray, non-marking, oil containing
- wheel center: high-quality polypropylene, impact resistant, color black

Other features:

- with synthetic thread guard, large
- very high chemical resistance to many aggressive substances
- operating temperature: -20 °C to +60 °C, reduced load capacity over +30 °C
- tread contains oil, may stain sensitive surfaces. alternatives: series VPA, PATH
- electrical conductivity (ohmic resistance) $\leq 10^4 \Omega$

Technical data:

Wheel Ø (D)	☯	75 mm
Wheel width	⊥	25 mm
Number of wheels		2
Load capacity at 3 km/h	⚖	100 kg
Load capacity (static)	⚖	250 kg
Bearing type	⦿	ball bearing (C)
Total height (H)	⌀	98 mm
Plate Ø	⌀	55 mm
Bolt hole	⦿	10,2 mm
Offset (F)	⌀	34 mm
Temperature resistance min		-20 °C
Temperature resistance max		60 °C
Tread and tyre hardness		85 Shore A
Unit weight	⚖	0.6 kg
Non-marking		✓
Non-staining		✗
Antistatic	⚡	✗
Electrically conductive	⚡	✓
Corrosion-resistant		✗
Heat-resistant	🔥	✗
Tread hydrolysis-resistant		✗
Suitable for autoclaves		✗
Suitable for machine washing		✗



Tread and tyre hardness

■ ■ ■ ■ ■ 85 Shore A

Rolling resistance

■ ■ ■ ■ ■ very good

Wear resistance

■ ■ ■ ■ ■ satisfactory

Operating noise / floor surface preservation

■ ■ ■ ■ ■ good

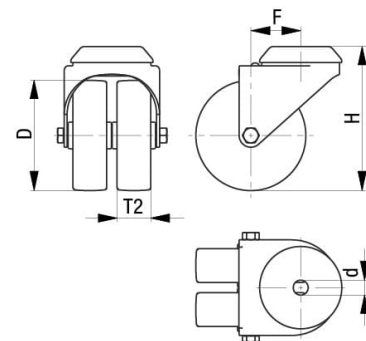
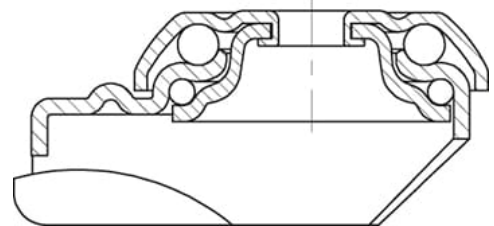

Product references



Corresponding swivel caster LMDA-TPA 75KF-ELS



Wheel used TPA 75/6KF-ELS