

B-VE 200R-SG-FA

Pressed steel fixed caster, medium duty design, with top plate fitting, wheel with standard solid rubber tire, with pressed steel rim, non-marking, gray, with steel thread guard

EAN 4047526637910

ID 637918

Customs tariff number 87169090



rig: B series

- pressed steel, zinc-plated, blue-passivated, Cr6-free

Wheel: VE series

- tire: standard solid rubber, hardness 80 Shore A, color gray, non-marking
- rim: pressed steel, zinc-plated, blue-passivated, Cr6-free

Other features:

- chemical resistance to many aggressive substances, except oils
- operating temperature: -25 °C to +80 °C, reduced load capacity over +60 °C

Technical data:

Wheel Ø (D)	☞	200 mm
Wheel width	⏏	50 mm
Load capacity at 4 km/h	⚖	205 kg
Load capacity (static)	⚖	515 kg
Bearing type	⦿	roller bearing
Total height (H)	⏏	235 mm
Plate size	📏	140 x 110 mm
Bolt hole spacing	📏	105 x 75–80 mm
Bolt hole Ø	🔧	11 mm
Temperature resistance min		-25 °C
Temperature resistance max		80 °C
Tread and tyre hardness		80 Shore A
Unit weight	⚖	2.7 kg
Non-marking	✓	
Non-staining	✓	
Antistatic	✗	
Electrically conductive	✗	
Corrosion-resistant	✗	
Heat-resistant	✗	
Tread hydrolysis-resistant	✗	
Suitable for autoclaves	✗	
Suitable for machine washing	✗	



Tread and tyre hardness

■ ■ ■ □ □ 80 Shore A

Rolling resistance

■ ■ □ □ □ satisfactory

Wear resistance

■ □ □ □ □ sufficient

Operating noise / floor surface preservation

■ ■ ■ ■ □ very good

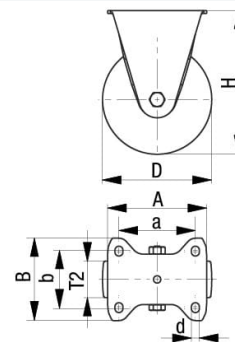

Product references



Corresponding swivel caster LE-VE 200R-SG-FA



Wheel used VE 200/20R-SG