

LEZ-VE 160R-27-SG

Pressed steel swivel caster, with stem fitting, wheel with standard solid rubber tire, with pressed steel rim, non-marking, gray

EAN 4047526646851

ID 646851

Customs tariff number 87169090



rig: LEZ series

- pressed steel, zinc-plated, blue-passivated, Cr6-free
- double ball bearing in the swivel head
- minimum swivel head play and smooth rolling characteristic and increased service life due to the special dynamic Blickle riveting process
- steel plug-in stem and central kingpin bolted and secured

Wheel: VE series

- tire: standard solid rubber, hardness 80 Shore A, color gray, non-marking
- rim: pressed steel, zinc-plated, blue-passivated, Cr6-free

Other features:

- chemical resistance to many aggressive substances, except oils
- operating temperature: -25 °C to +80 °C, reduced load capacity over +60 °C

Technical data:

Wheel Ø (D)	⌀	160 mm
Wheel width	⌀	40 mm
Load capacity at 4 km/h	⬇	135 kg
Load capacity (static)	⬇	340 kg
Bearing type	⊙	roller bearing
Total height (H)	⌀	195 mm
Stem Ø	⌀	27 mm
Stem length	⌀	60 mm
Offset (F)	⌀	54 mm
Temperature resistance min		-25 °C
Temperature resistance max		80 °C
Tread and tyre hardness		80 Shore A
Unit weight	⬆	2.8 kg
Non-marking		✓
Non-staining		✓
Antistatic	⚡	✗
Electrically conductive	⚡	✗
Corrosion-resistant		✗
Heat-resistant	🔥	✗
Tread hydrolysis-resistant		✗
Suitable for autoclaves		✗
Suitable for machine washing		✗



Tread and tyre hardness

■ ■ ■ ■ □ □ 80 Shore A

Rolling resistance

■ ■ □ □ □ □ satisfactory

Wear resistance

■ □ □ □ □ □ sufficient

Operating noise / floor surface preservation

■ ■ ■ ■ □ very good

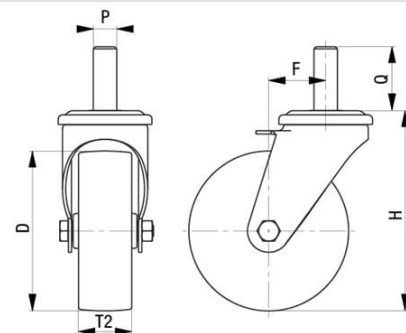
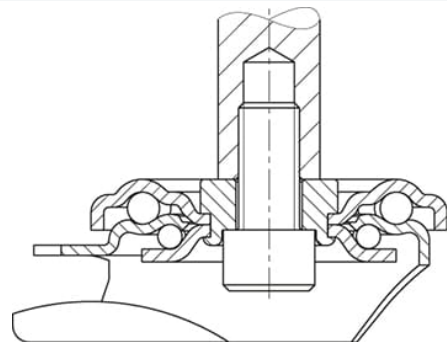

Product references



Corresponding standard locking LEZ-VE 160R-27-FI-SG



Wheel used VE 160/20R-SG