

## LEZ-VE 125R-SG

**Pressed steel swivel caster, with stem fitting, wheel with standard solid rubber tire, with pressed steel rim, non-marking, gray**

**EAN** 4047526650025

**ID** 650028

**Customs tariff number** 87169090



**rig:** LEZ series

- pressed steel, zinc-plated, blue-passivated, Cr6-free
- double ball bearing in the swivel head
- minimum swivel head play and smooth rolling characteristic and increased service life due to the special dynamic Blickle riveting process
- steel plug-in stem and central kingpin bolted and secured

**Wheel:** VE series

- tire: standard solid rubber, hardness 80 Shore A, color gray, non-marking
- rim: pressed steel, zinc-plated, blue-passivated, Cr6-free

**Other features:**

- chemical resistance to many aggressive substances, except oils
- operating temperature: -25 °C to +80 °C, reduced load capacity over +60 °C

**Technical data:**

Wheel Ø (D)	⌀	125 mm
Wheel width	⌀	37.5 mm
Load capacity at 4 km/h	⬇	100 kg
Load capacity (static)	⬇	250 kg
Bearing type	⊙	roller bearing
Total height (H)	⌀	150 mm
Stem Ø	⌀	20 mm
Stem length	⌀	50 mm
Offset (F)	⌀	38 mm
Temperature resistance min		-25 °C
Temperature resistance max		80 °C
Tread and tyre hardness		80 Shore A
Unit weight	⬆	1.1 kg
Non-marking		✓
Non-staining		✓
Antistatic	⚡	✗
Electrically conductive	⚡	✗
Corrosion-resistant		✗
Heat-resistant	🔥	✗
Tread hydrolysis-resistant		✗
Suitable for autoclaves		✗
Suitable for machine washing		✗



**Tread and tyre hardness**

■ ■ ■ ■ □ □ 80 Shore A

**Rolling resistance**

■ ■ □ □ □ □ satisfactory

**Wear resistance**

■ □ □ □ □ □ sufficient

**Operating noise / floor surface preservation**

■ ■ ■ ■ □ very good

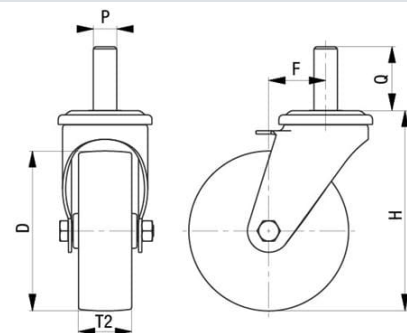
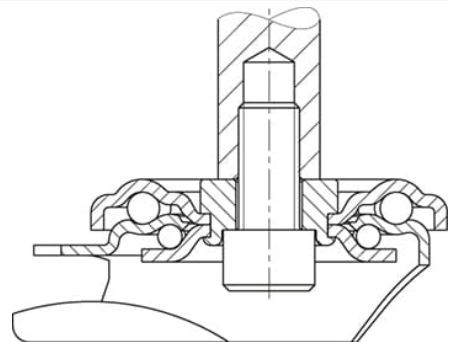

## Product references



**Corresponding standard locking LEZ-VE 125R-FI-SG**



**Wheel used VE 125/12R-SG**