

## LER-VE 150R-SG

**Pressed steel swivel caster, with bolt hole fitting, wheel with standard solid rubber tire, with pressed steel rim, non-marking, gray**

**EAN** 4047526698393

**ID** 698399

**Customs tariff number** 87169090



**rig:** LER series

- pressed steel, zinc-plated, blue-passivated, Cr6-free
- double ball bearing in the swivel head
- strong central kingpin
- minimum swivel head play and smooth rolling characteristic and increased service life due to the special dynamic Blickle riveting process

**Wheel:** VE series

- tire: standard solid rubber, hardness 80 Shore A, color gray, non-marking
- rim: pressed steel, zinc-plated, blue-passivated, Cr6-free

**Other features:**

- chemical resistance to many aggressive substances, except oils
- operating temperature: -25 °C to +80 °C, reduced load capacity over +60 °C

**Technical data:**

Wheel Ø (D)	☉	150 mm
Wheel width	⊥	40 mm
Load capacity at 4 km/h	⬆	135 kg
Load capacity (static)	⬆	340 kg
Bearing type	⊙	roller bearing
Total height (H)	⌀	190 mm
Plate Ø	⌀	88 mm
Bolt hole	🔩	13 mm
Offset (F)	⌀	54 mm
Temperature resistance min		-25 °C
Temperature resistance max		80 °C
Tread and tyre hardness		80 Shore A
Unit weight	⚖	1.9 kg
Non-marking	✓	
Non-staining	✓	
Antistatic	⚡	×
Electrically conductive	⚡	×
Corrosion-resistant		×
Heat-resistant	🔥	×
Tread hydrolysis-resistant		×
Suitable for autoclaves		×
Suitable for machine washing		×



**Tread and tyre hardness**

■ ■ ■ ■ □ 80 Shore A

**Rolling resistance**

■ ■ □ □ □ satisfactory

**Wear resistance**

■ □ □ □ □ sufficient

**Operating noise / floor surface preservation**

■ ■ ■ ■ □ very good

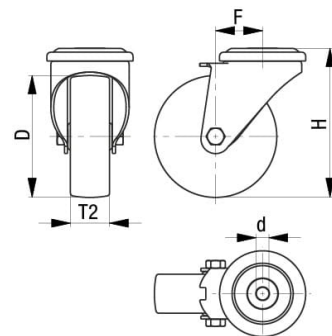
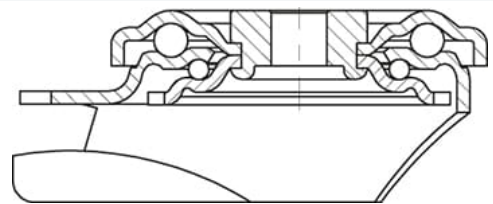

## Product references



**Corresponding standard locking LER-VE 150R-FI-SG**



**Wheel used VE 150/20R-SG**