

BH-GB 160K

Pressed steel fixed caster, heavy duty design, with top plate fitting, heavy duty wheel, with Blickle Besthane® polyurethane tread, with cast iron wheel center

EAN 4047526002473

ID 742256

Customs tariff number 87169090



rig: BH series

- pressed steel, zinc-plated, blue-passivated, Cr6-free
- heavy fork and top plate

Wheel: GB series

- tread: high-quality polyurethane elastomer Blickle Besthane®, hardness 92 Shore A, color brown, non-marking, non-staining
- wheel center: rugged gray cast iron, with grease nipple from wheel Ø 150 mm, lacquered, color silver

Other features:

- high chemical resistance to many aggressive substances
- operating temperature: -5 °F to +160 °F, temporarily up to +195 °F, reduced load capacity over +105 °F



Technical data:

| | | |
|------------------------------|---|----------------|
| Wheel Ø (D) | ☉ | 160 mm |
| Wheel width | ⊥ | 50 mm |
| Load capacity at 4 km/h | ⬆ | 800 kg |
| Load capacity (static) | ⬆ | 2,000 kg |
| Bearing type | ☉ | ball bearing |
| Total height (H) | ⊗ | 202 mm |
| Plate size | ☐ | 140 x 110 mm |
| Bolt hole spacing | ⊕ | 105 x 75–80 mm |
| Bolt hole Ø | ⌀ | 11 mm |
| Temperature resistance min | | -20 °C |
| Temperature resistance max | | 70 °C |
| Tread and tyre hardness | | 92 Shore A |
| Unit weight | ⚖ | 4.2 kg |
| Non-marking | ✓ | |
| Non-staining | ✓ | |
| Antistatic | ⊗ | × |
| Electrically conductive | ⊗ | × |
| Corrosion-resistant | × | |
| Heat-resistant | ⊗ | × |
| Tread hydrolysis-resistant | ✓ | |
| Suitable for autoclaves | × | |
| Suitable for machine washing | × | |

Tread and tyre hardness

■■■■■□ 92 Shore A

Rolling resistance

■■■■■□ excellent

Wear resistance

■■■■■□ excellent

Operating noise / floor surface preservation

■■■■■□ good

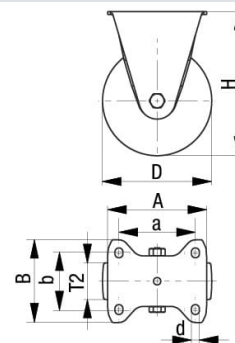

Product references



Corresponding swivel caster LUH-GB 160K



Wheel used GB 160/20K