

BH-PO 160K-FS

Pressed steel fixed caster, heavy duty design, with top plate fitting, and steel foot guard, nylon wheel

EAN 4047526235451

ID 742379

Customs tariff number 87169090



rig: BH series

- pressed steel, zinc-plated, blue-passivated, Cr6-free
- heavy fork and top plate

Wheel: PO series

- high-quality nylon 6, impact resistant, hardness 70 Shore D, color natural white

Other features:

- high chemical resistance to many aggressive substances
- operating temperature: -20 °C to +80 °C, reduced load capacity over +35 °C



Technical data:

Wheel Ø (D)	☞	160 mm
Wheel width	⏏	50 mm
Load capacity at 4 km/h	⚖	450 kg
Load capacity (static)	⚖	1,125 kg
Bearing type	⦿	ball bearing
Total height (H)	⊘	202 mm
Plate size	📏	140 x 110 mm
Bolt hole spacing	📏	105 x 75–80 mm
Bolt hole Ø	🔩	11 mm
Temperature resistance min		-20 °C
Temperature resistance max		80 °C
Tread and tyre hardness		70 Shore D
Unit weight	⚖	2.6 kg
Non-marking	✓	
Non-staining	✓	
Antistatic	✗	
Electrically conductive	✗	
Corrosion-resistant	✗	
Heat-resistant	✗	
Tread hydrolysis-resistant	✗	
Suitable for autoclaves	✗	
Suitable for machine washing	✗	

Tread and tyre hardness

70 Shore D

Rolling resistance

excellent

Wear resistance

good

Operating noise / floor surface preservation

satisfactory

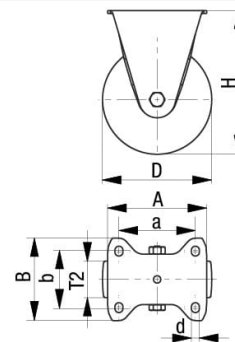

Product references



Corresponding swivel caster LH-PO 160K-FS



Wheel used PO 160/20K