

## LS-GST 202K

**Heavy duty welded steel swivel caster, heavy duty swivel head, heavy duty wheel, with Blickle Softhane® polyurethane tread, with cast iron wheel center**

**EAN** 4047526110451

**ID** 744928

**Customs tariff number** 87169090



**rig:** LS series

- particularly robust welded steel construction, zinc-plated, yellow-passivated, Cr6-free
- axial grooved ball bearing ISO 104 and tapered roller bearing ISO 355 in the swivel head
- bolted and secured welded central kingpin, extremely strong
- dust and splash-proof
- grease nipple

**Wheel:** GST series

- tread: high-quality polyurethane elastomer Blickle Softhane®, hardness 75 Shore A, color green, non-marking, non-staining
- wheel center: rugged gray cast iron, with grease nipple from wheel Ø 160 mm, lacquered, color silver

**Other features:**

- high chemical resistance to many aggressive substances
- operating temperature: -5 °F to +160 °F, temporarily up to +195 °F, reduced load capacity over +105 °F

**Technical data:**

Wheel Ø (D)	☉	200 mm
Wheel width	⊥	80 mm
Load capacity at 4 km/h	⚖	1,200 kg
Load capacity (static)	⚖	3,000 kg
Bearing type	☉	ball bearing
Total height (H)	⌀	255 mm
Plate size	☐	175 x 140 mm
Bolt hole spacing	⊞	140 x 105 mm
Bolt hole Ø	⌀	14 mm
Offset (F)	⌀	65 mm
Temperature resistance min		-20 °C
Temperature resistance max		70 °C
Tread and tyre hardness		75 Shore A
Unit weight	⚖	13 kg
Non-marking		✓
Non-staining		✓
Antistatic	⚡	✗
Electrically conductive	⚡	✗
Corrosion-resistant		✗
Heat-resistant	🔥	✗
Tread hydrolysis-resistant		✗



**Tread and tyre hardness**

■■■■■□□ 75 Shore A

**Rolling resistance**

■■■■■□ very good

**Wear resistance**

■■■■■□ very good

**Operating noise / floor surface preservation**

■■■■■□ very good

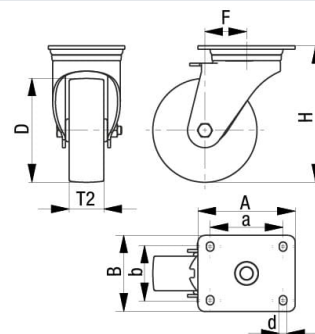
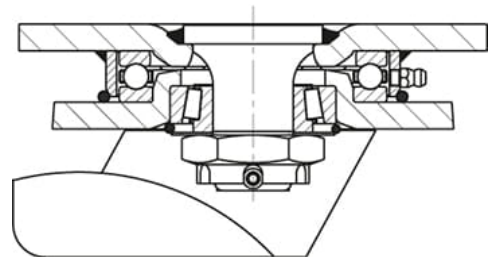

Suitable for autoclaves	×
Suitable for machine washing	×

## Product references



**Corresponding standard locking LS-GST 202K-ST**



**Corresponding rigid caster BS-GST 202K**



**Wheel used GST 202/25K**