

LER-PO 100KA-FI-FA

Pressed steel swivel caster, with bolt hole fitting, with brake system 'stop-fix', nylon wheel, with synthetic thread guard, small, with steel thread guard

EAN 4047526016593

ID 749750

Customs tariff number 87169090



rig: LER series

- pressed steel, zinc-plated, blue-passivated, Cr6-free
- double ball bearing in the swivel head
- strong central kingpin
- minimum swivel head play and smooth rolling characteristic and increased service life due to the special dynamic Blickle riveting process

Wheel: PO series

- high-quality nylon 6, impact resistant, hardness 70 Shore D, color natural white

Other features:

- with synthetic thread guard, small
- high chemical resistance to many aggressive substances
- operating temperature: -20 °C to +80 °C, reduced load capacity over +35 °C

Technical data:

Wheel Ø (D)	☉	100 mm
Wheel width	⊥	37 mm
Load capacity at 4 km/h	⬆	150 kg
Load capacity (static)	⬆	375 kg
Bearing type	☉	ball bearing (C)
Total height (H)	⌀	125 mm
Plate Ø	⌀	70 mm
Bolt hole	👁	13 mm
Offset (F)	⌀	36 mm
Temperature resistance min		-25 °C
Temperature resistance max		80 °C
Tread and tyre hardness		70 Shore D
Unit weight	⚖	0.8 kg
Non-marking		✓
Non-staining		✓
Antistatic	⚡	✗
Electrically conductive	⚡	✗
Corrosion-resistant		✗
Heat-resistant	🔥	✗
Tread hydrolysis-resistant		✗
Suitable for autoclaves		✗
Suitable for machine washing		✗



Tread and tyre hardness

70 Shore D

Rolling resistance

excellent

Wear resistance

good

Operating noise / floor surface preservation

satisfactory

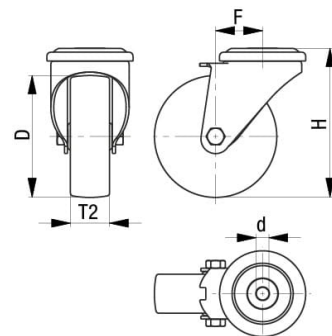
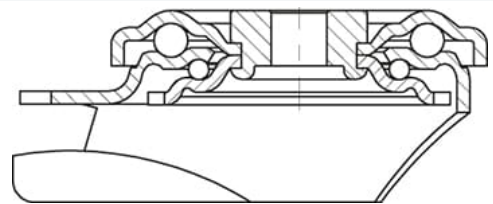

Product references



Corresponding swivel caster LER-PO 100KA-FA



Wheel used PO 100/8KA