

## LK-RD 125R-3-ST-VLI-FA

Pressed steel swivel caster, heavy duty design, with brake system 'stop-top', wheel with "Blickle Comfort" two-component solid rubber tires, with pressed steel rim, non-marking, gray, with steel thread guard

EAN 4047526029241

ID 750464

Customs tariff number 87169090



### rig: LK series

- strong pressed steel, zinc-plated, blue-passivated, Cr6-free
- double ball bearing in the swivel head
- strong central kingpin (from wheel Ø 125x50 mm)
- swivel head seal
- minimum swivel head play and smooth rolling characteristic and increased service life due to the special dynamic Blickle riveting process

### Wheel: RD series

- tire: two-component solid rubber "Blickle Comfort", hardness 56 Shore A, color gray
- rim: pressed steel, strong rim structure with tubular steel hub, bolted or pressed, zinc-plated, blue-passivated, Cr6-free

### Other features:

- chemical resistance to many aggressive substances, except oils
- operating temperature: -25 °C to +80 °C, reduced load capacity over +60 °C

### Technical data:

Wheel Ø (D)	☉	125 mm
Wheel width	⊥	37.5 mm
Load capacity at 4 km/h	⚖	120 kg
Load capacity (static)	⚖	300 kg
Bearing type	⦿	roller bearing
Total height (H)	⊕	155 mm
Plate size	📏	140 x 110 mm
Bolt hole spacing	📏	105 x 75–80 mm
Bolt hole Ø	🌀	11 mm
Offset (F)	📏	48 mm
Temperature resistance min		-25 °C
Temperature resistance max		70 °C
Tread and tyre hardness		56 Shore A
Unit weight	⚖	1.9 kg
Non-marking		✓
Non-staining		✓
Antistatic	⚡	✗
Electrically conductive	⚡	✗
Corrosion-resistant		✗
Heat-resistant	🔥	✗
Tread hydrolysis-resistant		✗
Suitable for autoclaves		✗



### Tread and tyre hardness

56 Shore A

### Rolling resistance

good

### Wear resistance

satisfactory

### Operating noise / floor surface preservation

very good

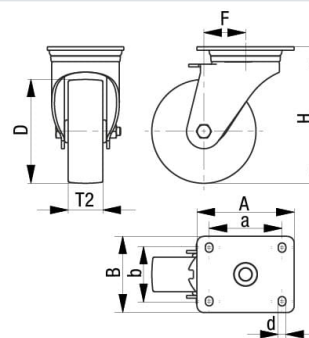
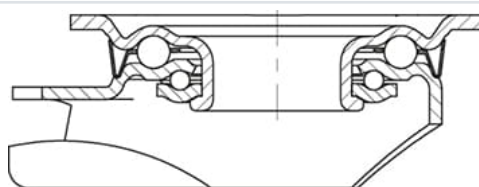

## Product references



**Corresponding rigid caster BK-RD 125R-3-VLI-FA**



**Corresponding swivel caster LK-RD 125R-3-VLI-FA**



**Wheel used RD 125/15R-VLI**