

LHZ-SPO 200G

Pressed steel swivel caster, heavy duty design, with stem fitting, nylon heavy duty wheel

EAN 4047526083311

ID 754673

Customs tariff number 87169090



rig: LHZ series

- strong pressed steel, zinc-plated, blue-passivated, Cr6-free
- heavy fork and top plate
- double ball bearing in the swivel head
- very strong, welded steel plug-in stem, bolted and secured
- particularly resistant to shocks and impact due to **four specially-shaped, hardened bearing seats**

Wheel: SPO series

- high-quality nylon 6, impact resistant, hardness 70 Shore D, extremely robust heavy-duty version, color natural white

Other features:

- high chemical resistance to many aggressive substances
- operating temperature: -25 °C to +80 °C, reduced load capacity over +35 °C
- Extra heavy-duty wheel design

Technical data:

Wheel Ø (D)	☉	200 mm
Wheel width	⊥	50 mm
Load capacity at 4 km/h	⚖	900 kg
Load capacity (static)	⚖	2,250 kg
Bearing type	⊙	plain bore
Total height (H)	⊕	245 mm
Stem Ø	⊥	27 mm
Stem length	⊥	60 mm
Offset (F)	⊕	70 mm
Temperature resistance min		-25 °C
Temperature resistance max		80 °C
Tread and tyre hardness		70 Shore D
Unit weight	⚖	3.8 kg
Non-marking		✓
Non-staining		✓
Antistatic	⚡	✗
Electrically conductive	⚡	✗
Corrosion-resistant		✗
Heat-resistant	🔥	✗
Tread hydrolysis-resistant		✗
Suitable for autoclaves		✗
Suitable for machine washing		✗



Tread and tyre hardness

■■■■■ 70 Shore D

Rolling resistance

■■■■■ excellent

Wear resistance

■■■■■ good

Operating noise / floor surface preservation

■■■■■ satisfactory

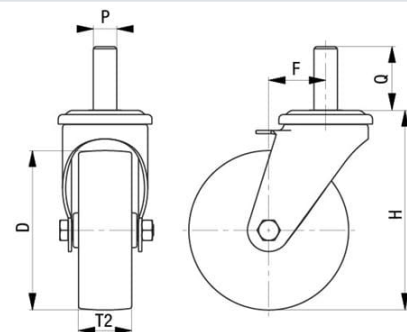
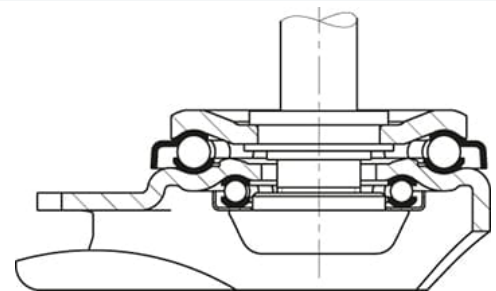

Product references



Corresponding standard locking LHZ-SPO 200G-FI



Wheel used SPO 200/20G