

## B-PO 60G

**Pressed steel fixed caster, medium duty design, with top plate fitting, nylon wheel**

**EAN** 4047526072384  
**ID** 755538  
**Customs tariff number** 83022000



**rig:** B series

- pressed steel, zinc-plated, blue-passivated, Cr6-free

**Wheel:** PO series

- high-quality nylon 6, impact resistant, hardness 70 Shore D, color natural white

**Other features:**

- high chemical resistance to many aggressive substances
- operating temperature: -25 °C to +80 °C, reduced load capacity over +35 °C

**Technical data:**

Wheel Ø (D)	⌀	60 mm
Wheel width	⊥	29 mm
Load capacity at 3 km/h	⬆	150 kg
Load capacity at 4 km/h	⬆	150 kg
Load capacity (static)	⬆	375 kg
Bearing type	⦿	plain bore
Total height (H)	⊘	80 mm
Plate size	⌘	100 x 85 mm
Bolt hole spacing	⌘	80 x 60 mm
Bolt hole Ø	⌀	9 mm
Temperature resistance min		-25 °C
Temperature resistance max		80 °C
Tread and tyre hardness		70 Shore D
Unit weight	⚖	0.3 kg
Non-marking		✓
Non-staining		✓
Antistatic	⚡	×
Electrically conductive	⚡	×
Corrosion-resistant		×
Heat-resistant	🔥	×
Tread hydrolysis-resistant		×
Suitable for autoclaves		×
Suitable for machine washing		×



**Tread and tyre hardness**



**Rolling resistance**



**Wear resistance**



**Operating noise / floor surface preservation**

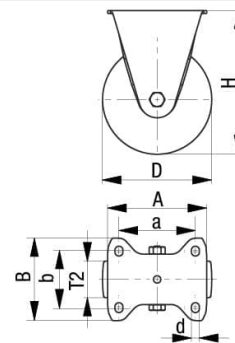

## Product references



**Corresponding swivel caster LE-PO 60G**



**Wheel used PO 60/12G**