

## L-POEV 200KAD-CS11-SB-FA

Pressed steel swivel caster, medium duty design, with top plate fitting, with central brake system 'central-stop', heavy duty wheel, with "Blickle EasyRoll" elastic solid rubber tires, with nylon wheel center, non-marking, blue, with synthetic thread guard, small, with additional ball bearing seals, with steel thread guard

EAN 4047526170264

ID 850746

Customs tariff number 87169090



### rig: L series

- pressed steel, zinc-plated, blue-passivated, Cr6-free
- double ball bearing in the swivel head
- strong central kingpin (from wheel Ø 150 mm)
- swivel head seal
- minimum swivel head play and smooth rolling characteristic and increased service life due to the special dynamic Blickle riveting process

### Wheel: POEV series

- tire: high-quality elastic solid rubber "Blickle EasyRoll" in smooth rolling quality, hardness 65 Shore A, color blue, non-marking
- wheel center: high-quality nylon 6, impact resistant, color black

### Other features:

- small thread guard, with additional, ball bearing seal
- high chemical resistance to many aggressive substances, except oils
- operating temperature: -5 °F to +175 °F, temporarily up to +210 °F, reduced load capacity over +95 °F

### Technical data:

Wheel Ø (D)	☉	200 mm
Wheel width	⊥	50 mm
Load capacity at 4 km/h	⬆	400 kg
Load capacity (static)	⬆	1,000 kg
Bearing type	☉	ball bearing (CC)
Total height (H)	⌀	235 mm
Plate size	☐	140 x 110 mm
Bolt hole spacing	⬆	105 x 75–80 mm
Bolt hole Ø	⌀	11 mm
Offset (F)	☉	63 mm
Temperature resistance min		-20 °C
Temperature resistance max		70 °C
Tread and tyre hardness		65 Shore A
Unit weight	⬆	3.3 kg
Non-marking		✓
Non-staining		✓
Antistatic	☐	×
Electrically conductive	☐	×
Corrosion-resistant		×
Heat-resistant	☐	×



### Tread and tyre hardness

65 Shore A

### Rolling resistance

very good

### Wear resistance

good

### Operating noise / floor surface preservation

very good

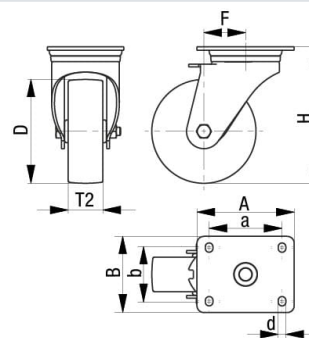
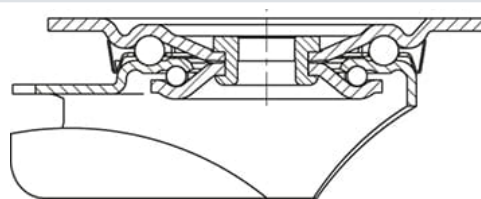

Tread hydrolysis-resistant	×
Suitable for autoclaves	×
Suitable for machine washing	×

## Product references



**Corresponding rigid caster B-POEV 200KAD-SB-FA**



**Corresponding swivel caster L-POEV 200KAD-SB-FA**



**Wheel used POEV 200/12KAD-SB**