

## BK-PO 100XR-1-FA

**Pressed steel fixed caster, heavy duty design, with top plate fitting, nylon wheel, with steel thread guard**

**EAN** 4047526196349  
**ID** 852729  
**Customs tariff number** 87169090



**rig:** BK series

- strong pressed steel, zinc-plated, blue-passivated, Cr6-free

**Wheel:** PO series

- high-quality nylon 6, impact resistant, hardness 70 Shore D, color natural white

**Other features:**

- high chemical resistance to many aggressive substances
- operating temperature: -25 °C to +80 °C, reduced load capacity over +35 °C



**Technical data:**

Wheel Ø (D)	☉	100 mm
Wheel width	⊥	37 mm
Load capacity at 4 km/h	⬆	280 kg
Load capacity (static)	⬆	700 kg
Bearing type	⊙	roller bearing
Total height (H)	⌀	130 mm
Plate size	☐	100 x 85 mm
Bolt hole spacing	⌓	80 x 60 mm
Bolt hole Ø	⌀	9 mm
Temperature resistance min		-25 °C
Temperature resistance max		80 °C
Tread and tyre hardness		70 Shore D
Unit weight	⚖	0.7 kg
Non-marking		✓
Non-staining		✓
Antistatic	⚡	×
Electrically conductive	⚡	×
Corrosion-resistant		×
Heat-resistant	🔥	×
Tread hydrolysis-resistant		×
Suitable for autoclaves		×
Suitable for machine washing		×

**Tread and tyre hardness**

■■■■■ 70 Shore D

**Rolling resistance**

■■■■■ excellent

**Wear resistance**

■■■■□□ good

**Operating noise / floor surface preservation**

■■■□□□ satisfactory

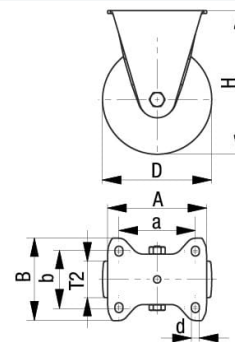

## Product references



**Corresponding swivel caster LK-PO 100XR-1-FA**



**Wheel used PO 100/15XR**