

BK-POTHS 125R-3

Pressed steel fixed caster, heavy duty design, with top plate fitting, wheel with soft thermoplastic polyurethane tread, with heavy duty nylon wheel center

EAN 4047526387037

ID 936314

Customs tariff number 87169090



rig: BK series

- strong pressed steel, zinc-plated, blue-passivated, Cr6-free

Wheel: POTHS series

- tread: high-quality thermoplastic polyurethane (TPU), hardness 80 Shore A, color blue, non-marking, non-staining
- wheel center: high-quality nylon 6, impact resistant, color natural white

Other features:

- very high chemical resistance to many aggressive substances
- operating temperature: -15 °F to +160 °F, temporarily up to +195 °F, reduced load capacity over +95 °F

Technical data:

Wheel Ø (D)	🌀	125 mm
Wheel width	⏏	40 mm
Load capacity at 4 km/h	📦	275 kg
Load capacity (static)	📦	690 kg
Bearing type	🌀	roller bearing
Total height (H)	📏	155 mm
Plate size	📏	140 x 110 mm
Bolt hole spacing	📏	105 x 75–80 mm
Bolt hole Ø	📏	11 mm
Temperature resistance min		-25 °C
Temperature resistance max		70 °C
Tread and tyre hardness		80 Shore A
Unit weight	📏	0.9 kg
Non-marking	✓	
Non-staining	✓	
Antistatic	✗	
Electrically conductive	✗	
Corrosion-resistant	✗	
Heat-resistant	✗	
Tread hydrolysis-resistant	✗	
Suitable for autoclaves	✗	
Suitable for machine washing	✗	



Tread and tyre hardness

■ ■ ■ ■ □ □ 80 Shore A

Rolling resistance

■ ■ ■ ■ □ very good

Wear resistance

■ ■ ■ ■ □ good

Operating noise / floor surface preservation

■ ■ ■ ■ □ very good

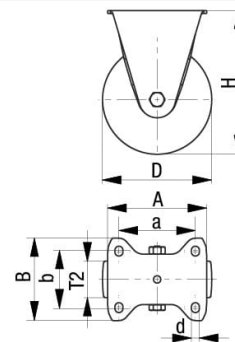

Product references



Corresponding swivel caster LK-POTHS 125R-3



Wheel used POTHs 125/15R