

B-PP 200K-EL

Pressed steel fixed caster, medium duty design, with top plate fitting, polypropylene wheel, electrically conductive

EAN 4047526375614

ID 951765

Customs tariff number 87169090



rig: B series

- pressed steel, zinc-plated, blue-passivated, Cr6-free

Wheel: PP series

- high-quality polypropylene, impact resistant, hardness 60 Shore D, color black

Other features:

- with synthetic thread guard, small
- high chemical resistance to many aggressive substances
- operating temperature: -20 °C to +60 °C, reduced load capacity over +30 °C
- electrical conductivity (ohmic resistance) $\leq 10^4 \Omega$

Technical data:

| | | |
|------------------------------|-----|----------------|
| Wheel Ø (D) | ☯ | 200 mm |
| Wheel width | ⏏ | 50 mm |
| Load capacity at 4 km/h | ⚖ | 400 kg |
| Load capacity (static) | ⚖ | 1,000 kg |
| Bearing type | ⦿ | ball bearing |
| Total height (H) | ⦶ | 235 mm |
| Plate size | 📏 | 140 x 110 mm |
| Bolt hole spacing | 📏 | 105 x 75–80 mm |
| Bolt hole Ø | 🔧 | 11 mm |
| Temperature resistance min | | -20 °C |
| Temperature resistance max | | 60 °C |
| Tread and tyre hardness | | 60 Shore D |
| Unit weight | ⚖ | 1.7 kg |
| Non-marking | ✗ | |
| Non-staining | ✓ | |
| Antistatic | 🔧 ✗ | |
| Electrically conductive | 🔧 ✓ | |
| Corrosion-resistant | ✗ | |
| Heat-resistant | 🔥 ✗ | |
| Tread hydrolysis-resistant | ✗ | |
| Suitable for autoclaves | ✗ | |
| Suitable for machine washing | ✗ | |



Tread and tyre hardness

■■■■■ 60 Shore D

Rolling resistance

■■■■■ very good

Wear resistance

■■■■■ satisfactory

Operating noise / floor surface preservation

■■■■■ satisfactory

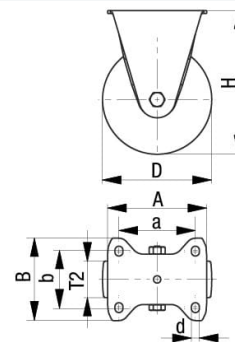

Product references



Corresponding swivel caster L-PP 200K-EL



Wheel used PP 200/20K-EL